

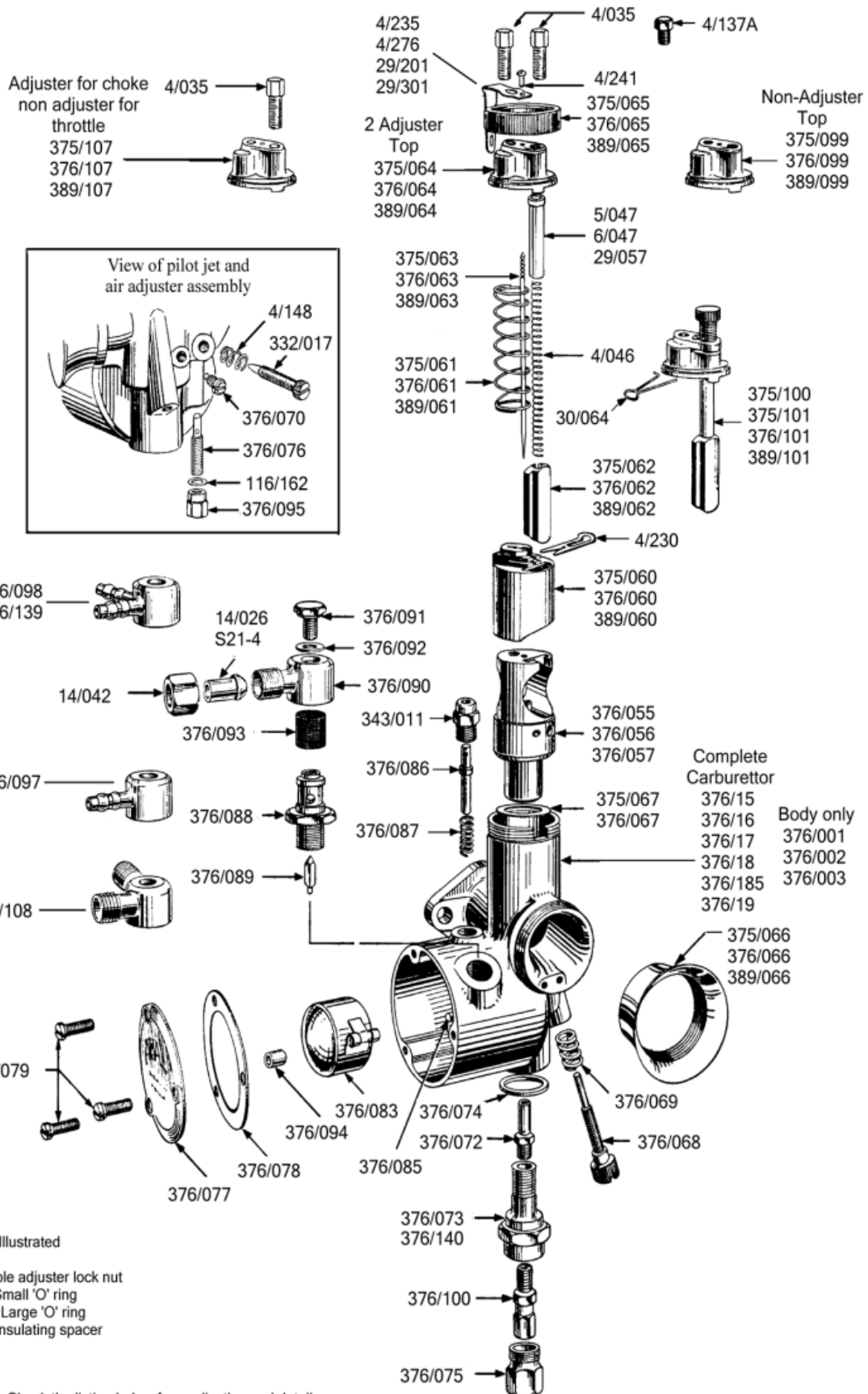

# AMAL Monobloc Carburetor

## Spare Parts List 375, 376 and 389



Check the listing below for application and details

**AMAL LTD., HOLDFORD ROAD, WITTON, BIRMINGHAM 6, ENGLAND**

Phone: Birmingham, BIRchfields 4571. (P.B.X. 6 lines)

Telegrams: "AMALCARB, 'PHONE BIRMINGHAM"



Component	Type		
	375	376	389
Mixing chamber body, type 375			
Mixing chamber body, type 376			
Mixing chamber body, type 389			
'O' ring for manifold joint, 1 3/8 outside diameter			
Jet block 21/32"	244/765	244/1048	244/1048
Jet block 23/32"	375/055	-	-
Jet block 25/32"	375/056	-	-
Jet block 13/16"	375/057	-	-
Jet block 7/8"	375/058	-	-
Jet block 15/16"	375/059	-	-
Jet block 1"	-	376/055	-
Jet block 1 1/10"	-	376/056	-
Jet block 1 3/32"	-	376/057	-
Jet block 1 1/8"	-	-	389/055
Jet block 1 5/32"	-	-	389/056
Jet block 1 5/16"	-	-	389/057
Locating peg for jet block	-	-	389/058
Washer for jet block	376/070	376/070	376/070
Mixing chamber top (Std)	375/067	376/067	376/067
Mixing chamber top for adjuster and ferrule	375/064	376/064	376/064
Mixing chamber top for two ferrules	375/107	376/107	376/107
Mixing chamber top cap ring	375/099	376/099	376/099
Cap spring for standard top	375/065	376/065	376/065
Cap spring for top with adjuster ferrule	4/235	4/235	29/201
Cap spring rod control, with adjuster	4/276	4/276	29/301
Cap spring rod control, with ferrule	375/070	29/235	389/067
Fixing screw for cap spring	375/071	29/308	389/068
Cable adjuster	4/241	4/241	4/241
Cable ferrules (Top hat)	4/035	4/035	4/035
Plug screw	6/132A	6/132A	6/132A
Throttle valve (Specify cutaway)	4/137A	4/137A	4/137A
Throttle valve spring (lighter than Std)	375/060	375/060	389/060
Throttle valve spring	-	376/132	
Throttle valve spring (Triumph T21)	375/061	376/061	389/061
Throttle valve spring (Carb. Pairs)	375/079	-	-
Taper needle	-	376/132	-
Taper needle (for alcohol only)	375/063	376/063	389/063
Needle clip	-	376/116	389/088
Air valve	4/230	4/230	4/230
Air valve guide	375/062	376/062	389/062
Air valve spring	5/047	6/047	29/057
Rod control air valve assembly	6/046	4/046	4/046
Rod control air valve assembly	375/101	376/101	389/101
Rod control air valve assembly	375/100	-	-
Rod control air valve assembly	375/102	-	-



Mixing chamber top (Rod control air valve with adjuster)	375/076	376/102	389/069
Mixing chamber top (Rod control air valve with ferrule)	375/086	376/166	389/094
Click spring	30/064	30/064	30/064
Air valve	375/108	376/166	389/090
Air valve spring	30/187	30/187	30/187
Operating rod and nut, -656" and -718" bores	375/115	376/183	389/093
Return spring, -656" and -718" bores	376/109	376/109	376/109
Operating rod and nut, -781", -812" and -875" bores	375/116	376/183	389/093
Return spring, -781", -812" and -875" bores	30/159	376/109	376/109
Needle jet	376/072	376/072	376/072
Needle jet (for alcohol only)	376/117	376/117	376/117
Main jet (Specify size)	376/100	376/100	376/100
Main jet holder (Standard)	376/073	376/063	376/073
Main jet holder (Special long)	-	376/140	-
Main jet holder Standard (Excelsior)	375/077	-	-
Main jet holder (Special short)	376/128	376/128	376/128
Main jet holder (for banjo)	-	376/140	-
Main jet holder washer	376/074	376/074	376/074
Main jet cover nut	376/075	376/075	-
Main jet cover nut	-	376/133	-
Pilot jet	376/076	376/076	376/076
Pilot jet cover nut	376/095	376/095	-
Pilot jet cover nut washer	116/162	116/162	-
Air adjusting screw	332/017	332/017	-
Air adjusting screw, hexagon head	-	376/119	-
Air adjusting screw spring	4/148	4/148	4/148
Throttle stop screw	376/068	376/068	-
Throttle stop screw (7/8 bore only)	376/160	-	-
Throttle stop screw spring	376/069	376/069	376/069
Air intake tube	229/048	376/066	-
Air intake tube, special short	375/078	-	-
Air intake screwed adaptor	224/886	376/110	389/072
Air tube (2 3/4" long)	-	376/143	-
Float, complete	376/083	376/083	376/083
Float hinge spindle	376/085	376/085	376/085
Float spindle bush	379/094	379/094	379/094
Float needle	376/089	376/089	376/089
Float needle (for alcohol only)	376/161	376/161	376/161
Needle seating	376/088	376/088	376/088
Needle seating (for alcohol only)	376/118	376/118	376/118
Needle seating washer	14/175	14/175	14/175
Banjo, single	375/068	375/068	375/068
Banjo, single	376/097	376/097	376/097
Banjo, single (for mixing chamber)	-	376/141	-
Banjo, single	376/090	376/090	376/090
Banjo, single	376/130	376/130	376/130

**AMAL LTD., HOLDFORD ROAD, WITTON, BIRMINGHAM 6, ENGLAND**

Phone: Birmingham, BIRchfields 4571. (P.B.X. 6 lines)

Telegrams: "AMALCARB, 'PHONE BIRMINGHAM"



Banjo, single	-	376/138	-
Banjo, double	376/098	376/098	376/098
Banjo, double	376/135	376/135	376/135
Banjo, double	376/139	376/139	376/139
Banjo, double (screwed) 1/4 B.S.P.	376/108	376/108	376/108
Banjo washer	14/175	14/175	14/175
Banjo bolt	376/091	376/091	376/091
Banjo bolt washer	376/092	376/092	376/092
Tickler	376/086	376/086	376/086
Tickler (Francis Barnett)	-	-	376/126
Tickler body	343/011	343/011	343/011
Tickler body (Francis Barnett)	-	-	376/125
Tickler spring	376/087	376/087	376/087
Float chamber cover	376/077	376/077	376/077
Float chamber cover joint	376/078	376/078	376/078
Float chamber cover screws	376/079	376/079	376/079
Filter gauze	376/093	376/093	376/093
Petrol union nut	14/042	14/042	14/042
Petrol union nipple	14/026	14/026	14/026
Monobloc Servicing Spanner (not illustrated)	244/1037	244/1037	244/1037

**For prices refer to list no, 101/1.**

**GUARANTEE.** – *The Company take all possible reasonable care in the manufacture and the quality of their products. Purchasers are informed that, any part proved to be defective in manufacture or quality, and returned to the works within six months of its purchase new, will be replaced. The Company must respectfully point out however, that it's responsibility and that of its agents, stockist and dealers, is limited to this Guarantee, and that they cannot, under any circumstances, be held responsible for any loss or for any contingent or resulting liability arising through any defect. These conditions of sale and use also apply when th Company's products form part of the original equipment of machines purchased new.*